

7.5 Hot Dipped Galvanised Flanges -
SABS 1123, BS 4504, ASA 150 and BS 10 - Table "D"

Table 7.5.1: BS 4504 10/3 - SABS 1123 1000/3 and BS 4504 16/3 - SABS 1123 1600/3

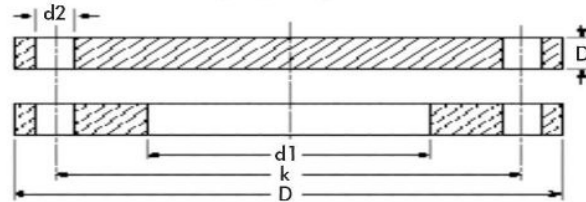

PIPE OD	BS 4504 10/3 – SABS 1123 1000/3								BS 4504 16/3 – SABS 1123 1600/3							
	DIMENSIONS				BOLTS				DIMENSIONS				BOLTS			
	D	d1	b	PCD (k)	Qty	d2	P-P	P-S	D	d1	b	PCD (k)	Qty	d2	P-P	P-S
20	95	30	10	65	4	M12	65	50	95	30	10	65	4	M12	65	50
25	105	38	10	75	4	M12	65	50	105	38	10	75	4	M12	65	50
32	115	45	10	85	4	M12	65	50	115	45	10	85	4	M12	65	50
40	140	52	10	100	4	M16	80	60	140	52	10	100	4	M16	80	60
50	150	63	10	110	4	M16	80	60	150	63	10	110	4	M16	80	60
63	165	74	12	125	4	M16	90	65	165	74	12	125	4	M16	90	65
75	185	86	12	145	4	M16	90	65	185	86	12	145	4	M16	90	65
90	200	103	12	160	8	M16	90	65	200	103	14	160	8	M16	90	65
110	220	136	12	180	8	M16	100	70	220	136	14	180	8	M16	100	70
125	220	136	12	180	8	M16	120	80	220	136	14	180	8	M16	120	80
140	250	158	14	210	8	M16	120	90	250	158	16	210	8	M16	120	90
160	285	190	16	240	8	M20	130	90	285	190	18	240	8	M20	130	90
180	285	190	16	240	8	M20	140	100	285	190	18	240	8	M20	140	100
200	340	237	18	295	8	M20	140	100	340	237	22	295	12	M20	150	100
225	340	237	18	295	8	M20	150	110	340	237	22	295	12	M20	160	120
250	395	279	18	350	12	M20	160	120	405	279	22	355	12	M20	170	120
280	395	292	20	350	12	M20	160	120	405	292	25	355	12	M20	170	130
315	445	330	22	400	12	M20	190	130	460	330	28	410	12	M20	190	140
355	505	376	25	460	16	M20	190	140	520	376	30	470	16	M20	200	150
400	565	430	25	515	16	M24	210	150	580	430	35	525	16	M24	240	170
450	615	476	30	565	20	M24	240	160	640	476	40	585	20	M24	250	180
500	670	533	30	620	20	M24	240	160								
560	730	592	35	675	20	M24	240	170								
630	835	662	36	780	20	M24	260	180								
710	895	737	40	840	24	M24	250	180								
800	1015	840	45	950	24	M30	280	210								
900	1115	942	50	1050	28	M30	310	240								
1000	1230	1045	55	1160	28	M30	340	250								

NOTE: The bolt diameters and length refer to flanges drilled to the above standard only - length of bolts allow for washers and gaskets.

PIPE OD	BS 10 TABLE "D"								ASA 150							
	DIMENSIONS				BOLTS				DIMENSIONS				BOLTS			
	D	d1	b	PCD (k)	Qty	d2	P-P	P-S	D	d1	b	PCD (k)	Qty	d2	P-P	P-S
20	95.3	30	5	66.7	4	M12	55	40	88.9	30	10	60.3	4	M12	65	50
25	101.6	38	5	73	4	M12	55	40	98.4	38	10	69.8	4	M12	65	50
32	114.3	45	5	82.6	4	M12	55	40	107.9	45	10	79.4	4	M12	65	50
40	120.7	52	6	87.3	4	M12	75	60	117.5	52	12	88.9	4	M12	90	65
50	133.4	63	6	98.4	4	M12	75	60	127	63	12	98.4	4	M16	90	65
63	152.4	74	8	114.3	4	M16	80	55	152.4	74	12	120.6	4	M16	90	65
75	165.1	86	8	127	4	M16	80	55	177.8	86	12	139.7	4	M16	90	65
90	184.1	103	10	146	4	M16	80	60	190.5	103	12	152.4	4	M16	90	65
110	215.9	136	10	177.8	4	M16	100	70	228.6	136	15	190.5	8	M16	110	80
125	215.9	136	10	177.8	4	M16	110	75	228.6	136	15	190.5	8	M16	120	90
140	254	158	13	209.6	8	M16	120	80	254	158	15	215.9	8	M20	120	90
160	279.4	190	13	235	8	M16	120	90	279.4	190	20	241.3	8	M20	140	100
180	279.4	190	13	235	8	M16	130	90	279.4	190	20	241.3	8	M20	150	110
200	336.6	237	13	292.1	8	M16	130	90	342.9	237	20	298.4	8	M20	150	110
225	336.6	237	13	292.1	8	M16	140	100	342.9	237	20	298.4	8	M20	160	110
250	406.4	279	16	355.6	8	M20	150	110	406.4	279	25	361.9	12	M24	170	130
280	406.4	292	16	355.6	8	M20	150	110	406.4	292	25	361.9	12	M24	170	130
315	457.2	330	19	406.4	12	M20	180	130	482.6	330	30	431.8	12	M24	220	150
355	527.1	376	22	469.9	12	M24	190	130	533.4	376	30	476.2	12	M24	200	150
400	577.9	430	22	520.7	12	M24	210	140	596.9	430	30	539.7	16	M24	220	160
450	641.4	476	25	584.2	12	M24	220	150	635	476	30	577.8	16	M30	240	160
500	704	533	29	641.4	16	M24	240	160	698.5	533	30	635	20	M30	240	160
560/600	825.5	592	30	755.7	16	M24	240	160	812.8	592	35	749.3	20	M32	240	170
630/650	825.5	662	32	755.7	16	M24	250	170								
710	908.1	737	35	844.6	20	M24	240	170								
800	-	-	-	-	-	-	-	-								
900	1174.7	942	48	1092.2	24	M32	310	220								
1000	1257.3	1045	51	1174.7	24	M32	330	240								

(All dimensions tabled in millimetres - mm)

7.6 Machined Plain Stubs PE-HD based on DIN 16963: Part 4

Table 7.6.1: PE 100 and PE 80

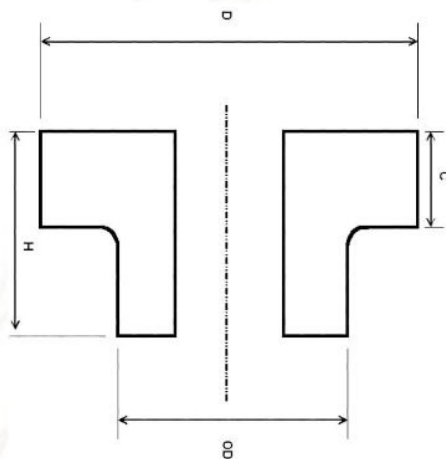

PIPE OD	PLAIN STUB DIMENSIONS										
	DIMENSIONS			INTERNAL DIAMETERS							
	D	H	C	SDR 33 (S ² 16)	SDR 26 (S 12.5)	SDR 21 (S 8.3)	SDR 17 (S 8)	SDR 13.6 (S 6.3)	SDR 11 (S 5)	SDR 9 (S 4)	SDR 7.4 (S 3.2)
20	46	40	15	-	-	-	-	-	-	-	-
25	56	40	15	-	-	-	-	-	-	19.1	17.6
32	65	40	15	-	-	-	-	-	25.9	24.4	22.7
40	73	50	20	-	35.1	-	-	-	32.2	30.5	28.3
50	83	50	20	-	45.1	-	-	-	40.2	38.1	35.3
63	98	50	20	58.1	57.7	-	-	53.0	50.7	47.9	44.7
75	110	50	20	70.2	69.0	-	65.6	63.2	60.6	57.2	53.1
90	129	50	20	84.2	82.7	81.0	78.6	75.8	72.6	68.5	63.8
110	160	60	27	103.0	101.3	99.0	96.2	92.9	88.9	83.9	77.9
125	160	78	35	117.0	115.0	112.5	109.4	105.6	100.8	95.3	87.8
140	188	68	35	131.2	128.8	126.0	122.6	118.3	113.1	106.7	98.3
160	217	70	35	149.9	147.1	143.9	140.0	135.1	129.0	121.2	112.4
180	217	85	40	168.7	165.7	162.1	157.5	151.9	144.6	136.4	126.5
200	270	75	40	187.3	184.0	179.9	175.0	168.9	160.6	151.4	140.4
225	270	90	45	210.8	207.2	202.4	196.8	189.2	180.7	170.3	158.0
250	325	80	45	234.2	230.1	225.2	218.9	210.4	200.9	189.5	175.6
280	325	90	45	262.4	257.8	252.0	244.4	235.6	225.1	212.1	196.7
315	375	100	55	295.1	289.9	283.7	274.9	265.0	253.1	238.6	221.2
355	430	100	55	332.6	326.8	319.0	309.6	298.7	285.3	268.8	249.5
400	486	110	65	374.7	368.3	359.2	349.1	336.6	321.4	302.9	281.0
450	540	112	70	421.7	413.5	404.2	392.7	378.6	361.5	340.8	316.4
500	585	106	70	468.6	459.5	449.0	436.2	420.6	401.7	378.9	-
560	645	108	70	523.9	514.7	503.0	488.7	471.1	450.0	-	-
630	685	120	77	589.5	578.9	566.0	549.7	530.1	506.2	-	-
710	800	120	70	664.1	652.2	637.5	619.4	597.3	-	-	-
800	905	120	77	748.1	734.7	718.2	697.8	672.8	-	-	-
900	1005	120	85	841.3	826.4	807.7	784.9	-	-	-	-
1000	1110	140	96	934.7	918.0	897.1	871.7	-	-	-	-

(All dimensions tabulated in millimetres - mm)